



INSTRUCTIONS FOR:
**PANEL STAND -
DOOR, WING, BONNET & BUMPER**
MODEL NO: MK51.V2

Thank you for purchasing a Sealey product. Manufactured to a high standard this product will, if used according to these instructions and properly maintained, give you years of trouble free performance.



IMPORTANT: PLEASE READ THESE INSTRUCTIONS CAREFULLY. NOTE THE SAFE OPERATIONAL REQUIREMENTS, WARNINGS, AND CAUTIONS. USE THIS PRODUCT CORRECTLY, AND WITH CARE FOR THE PURPOSE FOR WHICH IT IS INTENDED. FAILURE TO DO SO MAY CAUSE DAMAGE AND/OR PERSONAL INJURY AND WILL INVALIDATE THE WARRANTY.

1. SAFETY INSTRUCTIONS

- ✓ Only use on firm, level, unobstructed surfaces which are capable of supporting the stand and body panels.
- ✗ DO NOT overload.
- ✓ Always load evenly with the centre of gravity of the load as near the centre as possible.
- ✓ Apply the brakes before commencing work.
- ✗ DO NOT stand/ride on the stand, or allow others to do so.
- ✓ Replace or repair damaged parts. Use only recommended parts. Unauthorised parts may be dangerous and will invalidate the warranty.
- ☐ **WARNING!** Failure to comply with these instructions may result in loss of load, damage to the stand or other property and/or personal injury.
- ☐ **WARNING!** The warnings, cautions and instructions discussed in this instruction manual cannot cover all possible conditions and situations that may occur. It must be understood that common sense and caution are factors which cannot be built into this product, but must be applied by the operator.

2. INTRODUCTION & SPECIFICATION

Features fully adjustable arms to fit many styles of bonnets, wings, doors and bumpers. Main frame can adjust through 180°, to give required angle. Fitted with two fixed Ø 180mm wheels and two braked Ø 125mm castors for easy manoeuvrability.

Specification

Overall Arm Width: 935mm

Base Dimensions: 1110 x 780mm

3. ASSEMBLY

Assemble panel stand according to the diagram overleaf.



NOTE: It is our policy to continually improve products and as such we reserve the right to alter data, specifications and component parts without prior notice.

IMPORTANT: No liability is accepted for incorrect use of this product.

WARRANTY: Guarantee is 12 months from purchase date, proof of which will be required for any claim.

INFORMATION: For a copy of our latest catalogue and promotions call us on 01284 757525 and leave your full name and address, including postcode.



Sole UK Distributor, Sealey Group,
Kempson Way, Suffolk Business Park,
Bury St. Edmunds, Suffolk,
IP32 7AR



01284 757500



01284 703534



www.sealey.co.uk



sales@sealey.co.uk

Issue: 1
 Issue Date: 080413

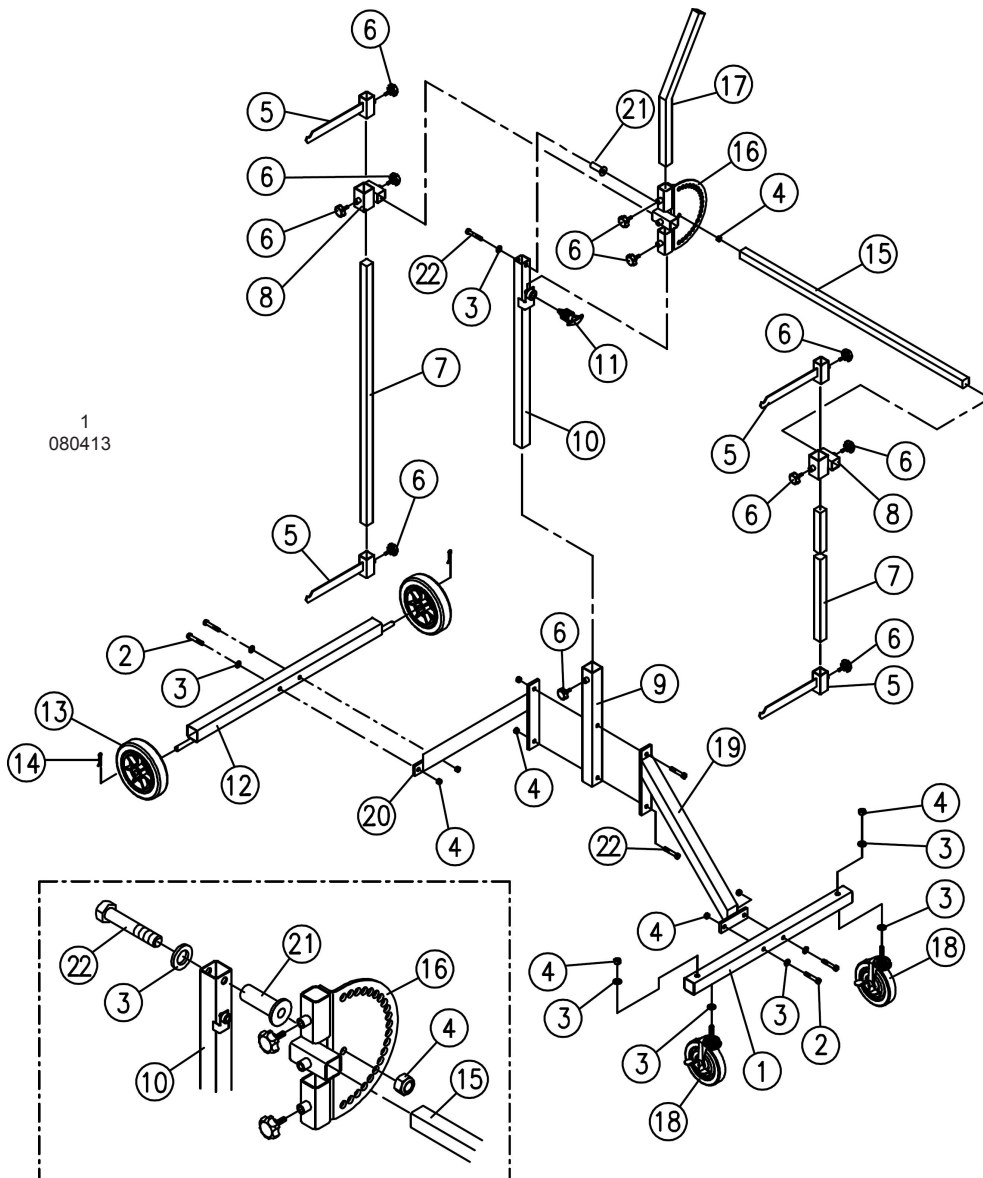

ITEM	PART NO	DESCRIPTION	ITEM	PART NO	DESCRIPTION
1	MK51.V2-01	SIDE LEG (BASE TUBE)	13	MK51.V2-13	WHEEL 175X37X13
2	MK51.V2-02	SCREW	14	MK51.V2-14	SNAP RING
3	MK51.V2-03	WASHER	15	MK51.V2-15	EXTENSION FRAME (CROSS TUBE)
4	MK51.V2-04	LOCK NUT	16	MK51.V2-16	ADJUSTABLE ANGLE BRACKET (ANGULAR DISC)
5	MK51.V2-05	SUPPORT FOR UPRIGHT (SET TUBE)	17	MK51.V2-17	EXTENSION FRAME
6	MK51.V2-06	KNOB	18	MK51.V2-18	WHEEL WITH BRAKE 122X25X11
7	MK51.V2-07	UPRIGHT FRAME,SIDE (ERECT TUBE)	19	MK51.V2-19	BASE SUPPORT (OBLIGUE TUBE)
8	MK51.V2-08	SUPPORT FOR UPRIGHT (SET TUBE)	20	MK51.V2-20	BASE SUPPORT (OBLIGUE TUBE)
9	MK51.V2-09	UPRIGHT FRAME SUPPORT (BOTTOM ERECT TUBE)	21	MK51.V2-21	BUSHING
10	MK51.V2-10	UPRIGHT FRAME (TOP ERECT TUBE)	22	MK51.V2-22	SCREW (3/8x2-1/2")
11	MK51.V2-11	LOCK PIN			
12	MK51.V2-12	SIDE LEG (BASE TUBE)			

NOTE: It is our policy to continually improve products and as such we reserve the right to alter data, specifications and component parts without prior notice.

IMPORTANT: No liability is accepted for incorrect use of product.

WARRANTY: Guarantee is 12 months from purchase date, proof of which will be required for any claim.

INFORMATION: For a copy of our latest catalogue and promotions call us on 01284 757525 and leave your full name and address, including postcode.