

Issue. 1  
Date. 051104

### RE97XC10

ITEM	PART NO	DESCRIPTION
1	RE97XC10.01	RAMMER
2	RE97XC10.02	STEEL BALL
3	RE97XC10.03	SPRING
4	RE97XC10.04	SCREW
5	RE97XC10.05	RAM
6	RE97XC10.06	PIN
7	RE97XC10.07	GUIDING COLLAR
8	RE97XC10.08	CAP (NYLON)
9	RE97XC10.09	O-RING
10	RE97XC10.10	SPRING
11	RE97XC10.11	NUT
12	RE97XC10.12	CYLINDER
13	RE97XC10.13	O-RING
14	RE97XC10.14	COVER NUT
15	RE97XC10.15	PIN
16	RE97XC10.16	SPINDLE SCREW
17	RE97XC10.17	SPRING
18	RE97XC10.18	SPINDLE
19	RE97XC10.19	OIL RING
20	RE97XC10.20	CONNECTION NUT
21	RE97XC10.21	HOSE COUPLER
22	RE97XC10.22	O RING
23	RE97XC10.23	DUST CAP

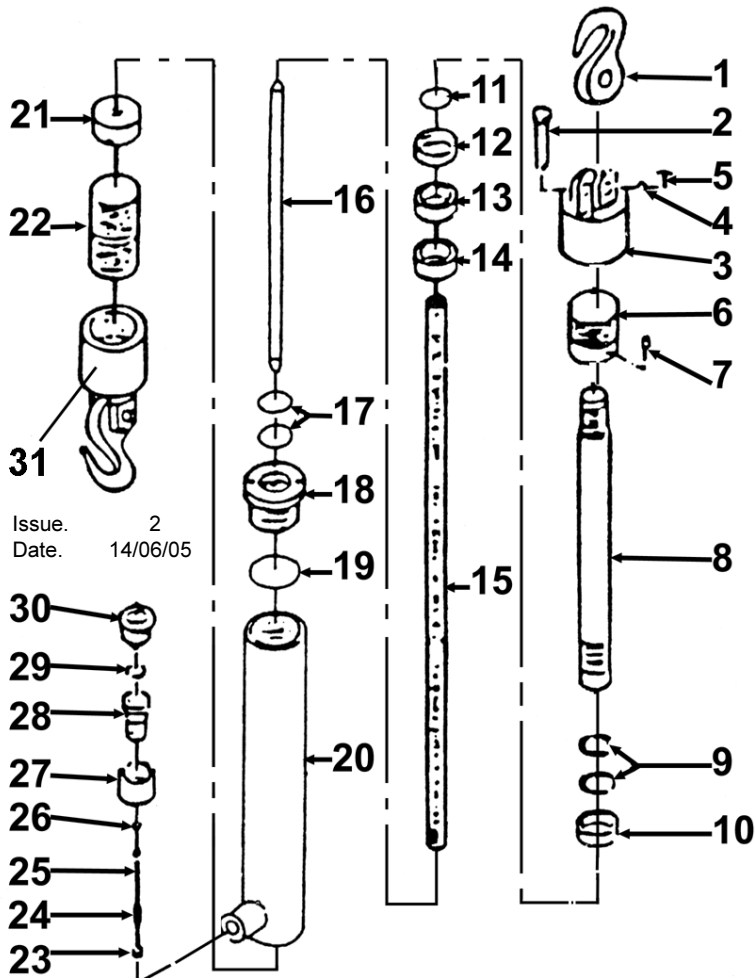

Issue. 2  
Date. 14/06/05

### RE97XM02

ITEM	PART NO	DESCRIPTION
1	RE97XM02.01	HOOK
2	RE97XM02.02	AXLE PIN
3	RE97XM02.03	COUPLING FORG
4	RE97XM02.04	COLLAR
5	RE97XM02.05	SPLIT PIN
6	RE97XM02.06	NUT
7	RE97XM02.07	SCREW
8	RE97XM02.08	RAM
9	RE97XM02.09	CLOSING RING
10	RE97XM02.10	CARRIER RING
11	RE97XM02.11	O-RING
12	RE97XM02.12	U-TYPE PACKING
13	RE97XM02.13	GUIDING COLLAR
14	RE97XM02.14	NUT
15	RE97XM02.15	SPRING
16	RE97XM02.16	SHAFT
17	RE97XM02.17	O-RING
18	RE97XM02.18	NUT
19	RE97XM02.19	O-RING
20	RE97XM02.20	CYLINDER
21	RE97XM02.21	NUT
22	RE97XM02.22	SCREW COUPLER
23	RE97XM02.23	SPINDLE SCREW
24	RE97XM02.24	SPRING
25	RE97XM02.25	SPINDLE
26	RE97XM02.26	OIL RING
27	RE97XM02.27	CONNECTION NUT
28	RE97XM02.28	HOSE COUPLER
29	RE97XM02.29	O-RING
30	RE97XM02.30	DUST CAP
31	RE97XM02.H-F	HOOK, FEMALE
32	RE97XM02.H-M	HOOK, MALE