

Issue: 1  
 Issue Date: 080710

**NOTE:** It is our policy to continually improve products and as such we reserve the right to alter data, specifications and component parts without prior notice.

**IMPORTANT:** No liability is accepted for incorrect use of product.

**WARRANTY:** Guarantee is 12 months from purchase date, proof of which will be required for any claim.

**INFORMATION:** For a copy of our latest catalogue and promotions call us on 01284 757525 and leave your full name and address, including postcode.

<b>PC2950.V4.K1</b>		<b>MOTOR/PUMP ASSEMBLY</b>	97	FNA.37009600	CAPACITOR
1	FNA.10002500	MOTOR	103	FNA.42027000	SWITCH COVER
2	FNA.43012600	CAM	104	FNA.22006200	COVER GASKET
3	FNA.21006500	WOBBLE PLATE SCREW (LEFT)	105	FNA.21035300	SCREW
4	FNA.43009800	SHEET METAL	106	FNA.21031600	PLAIN PAD
5	FNA.23000900	ROLLER	107	FNA.22006900	PEDESTAL SMALL O-RING
6	FNA.43009900	HEAVY PLATE	108	FNA.42027600	SWITCH PEDESTAL
7	FNA.43009100	PISTON SPRING SEAT	109	FNA.22007100	PEDESTAL BIG O-RING
8	FNA.43010000	PISTON			
9	FNA.43010500	PISTON SPRING		<b>PC2950.V5.K2</b>	<b>MOTOR ASSEMBLY</b>
10	FNA.26001300	RUBBER SEAL	1	FNA.10002500	MOTOR
11	FNA.43008800	PISTON BODY	2	FNA.43012600	CAM
12	FNA.41003400	PISTON SEAL	3	FNA.21006500	WOBBLE PLATE SCREW (LEFT)
13	FNA.22005200	SMALL O-RING			
14	FNA.42020800	PILOT SHEATH		<b>PC2950.V4.K3</b>	<b>BEARING ASSEMBLY</b>
15	FNA.42021200	GRAPHITE RING	4	FNA.43009800	SHEET METAL
16	FNA.22005100	PISTON O-RING	5	FNA.23000900	ROLLER
17	FNA.22004300	O-RING PILOT SHEATH	6	FNA.43009900	HEAVY PLATE
18	FNA.22004200	O-RING			
19	FNA.42020900	CHECK VALVE COUPLING		<b>PC2950.V4.K4</b>	<b>PISTON BODY ASS'Y</b>
20	FNA.42021100	CHECK VALVE PEDESTAL	9	FNA.43010500	PISTON SPRING
21	FNA.43010300	CHECK VALVE SPRING	10	FNA.26001300	RUBBER SEAL
22	FNA.43009200	CHECK VALVE	11	FNA.43008800	PISTON BODY
23	FNA.42021000	CHECK VALVE COVER	12	FNA.41003400	PISTON SEAL
24	FNA.22004400	CHECK VALVE O-RING	13	FNA.22005200	SMALL O-RING
25	FNA.43016800	PUMP BODY			
27	FNA.21006400	CAP SCREW		<b>PC2950.V4.K5</b>	<b>PISTON ASS'Y</b>
28	FNA.41003200	INLET PIPE SEAL RING	7	FNA.43009100	PISTON SPRING SEAT
29	FNA.42043800	INLET PIPE	8	FNA.43010000	PISTON
30	FNA.21006600	HEAD CAP SCREW			
30-1	FNA.21008400	PLAIN CUSHION		<b>PC2950.V4.K6</b>	<b>PILOT SHEATH ASS'Y</b>
35	FNA.42000300	INLET FILTER		FNA.42020800	PILOT SHEATH
58	FNA.22005400	O-RING	14	FNA.42021200	GRAPHITE RING
59	FNA.22004800	O-RING	15	FNA.22005100	PISTON O-RING
60	FNA.43010200	SCREW	16		
61	FNA.43009300	U-PIN		<b>PC2950.V4.K7</b>	<b>PUMP BODY ASS'Y</b>
62	FNA.21006700	HEAD CAP SCREW		FNA.22004300	O-RING PILOT SHEATH
64	FNA.43013800	OUTLET BODY	17	FNA.22004200	O-RING
65	FNA.22004500	O-RING	18	FNA.42020900	CHECK VALVE COUPLING
66	FNA.42021700	VALVE CORE	19	FNA.43016800	PUMP BODY
67	FNA.43010400	VALVE CORE SPRING	25		
68	FNA.43010100	PLUG SCREW		<b>PC2950.V4.K8</b>	<b>ONE WAY VALVE ASS'Y</b>
69	FNA.42021900	STEEL BALL COVER		FNA.42021100	CHECK VALVE PEDESTAL
70	FNA.23000400	STEEL BALL (6.9mm)	20	FNA.43010300	CHECK VALVE SPRING
71	FNA.22004600	O-RING	21	FNA.43009200	CHECK VALVE
72	FNA.42022000	SPILL VALVE SHELL	22	FNA.42021000	CHECK VALVE COVER
73	FNA.41003000	CLOSING RING	23	FNA.22004400	CHECK VALVE O-RING
74	FNA.22004600	O-RING	24		
75	FNA.43008200	SPILL VALVE CORE		<b>PC2950.V4.K9</b>	<b>INLET PIPE ASS'Y</b>
76	FNA.22006900	PEDESTAL SMALL O-RING	28	FNA.41003200	INLET PIPE SEAL RING
77	FNA.41009300	CLOSING RING	29	FNA.42043800	INLET PIPE
78	FNA.22003700	O-RING	35	FNA.42000300	INLET FILTER
79	FNA.42021800	SPILL VALVE JACKET			
80	FNA.22004700	O-RING		<b>PC2950.V4.K10</b>	<b>INLET CONNECTOR ASS'Y</b>
81	FNA.43009400	CLOSING RING		FNA.22005300	WATER INLET O-RING
82	FNA.43009700	SPILL VALVE SPRING	32	FNA.42044000	WATER INLET CONNECTION
83	FNA.43044300	FEELER LEVER	33	FNA.41003300	WATER INLET CONNECTION FILTER PAD
84	FNA.43012900	CONNECTING ROD	34		
85	FNA.21006800	FEELER LEVER NUT		<b>PC2950.V4.K11</b>	<b>OUTLET BODY ASS'Y</b>
86	FNA.25000300	NUT	58	FNA.22005400	O-RING
88	FNA.42057100	PIN	59	FNA.22004800	O-RING
89	FNA.41003500	FEELER LEVER JACKET	60	FNA.43010200	SCREW
90	FNA.21031800	PAD	61	FNA.43009300	U-PIN
91	FNA.43044000	ROCKER SWITCH PIN	64	FNA.43013800	OUTLET BODY
92	FNA.43043900	VALVE CORE	65	FNA.22004500	O-RING
93	FNA.21033200	SCREW	66	FNA.42021700	VALVE CORE
93-1	FNA.21009700	SCREW	67	FNA.43010400	VALVE CORE SPRING
94	FNA.33000800	MAIN SWITCH			
95	FNA.22006400	RUBBER STOP			
96	FNA.22006300	CAPACITOR O-RING			

**NOTE:** It is our policy to continually improve products and as such we reserve the right to alter data, specifications and component parts without prior notice.

**IMPORTANT:** No liability is accepted for incorrect use of product.

**WARRANTY:** Guarantee is 12 months from purchase date, proof of which will be required for any claim.

**INFORMATION:** For a copy of our latest catalogue and promotions call us on 01284 757525 and leave your full name and address, including postcode.

68	FNA.43010100	PLUG SCREW			
69	FNA.42021900	STEEL BALL COVER			
70	FNA.23000400	STEEL BALL (6.9mm)			
71	FNA.22004600	O-RING			
72	FNA.42022000	SPILL VALVE SHELL			
	<b>PC2950.V4.K12</b>	<b>VALVE SHEATH ASS'Y</b>			
73	FNA.41003000	CLOSING RING			
74	FNA.22004600	O-RING			
75	FNA.43008200	SPILL VALVE CORE			
76	FNA.22006900	PEDESTAL SMALL O-RING			
77	FNA.41009300	CLOSING RING			
78	FNA.22003700	O-RING			
79	FNA.42021800	SPILL VALVE JACKET			
80	FNA.22004700	O-RING			
81	FNA.43009400	CLOSING RING			
82	FNA.43009700	SPILL VALVE SPRING			
83	FNA.43044300	FEELER LEVER			
84	FNA.43012900	CONNECTING ROD			
85	FNA.21006800	FEELER LEVER NUT			
86	FNA.25000300	NUT			
	<b>PC2950.V4.K13</b>	<b>SWITCH PEDESTAL ASS'Y</b>			
87	FNA.33000700	MICRO SWITCH			
88	FNA.42057100	PIN			
89	FNA.41003500	FEELER LEVER JACKET			
90	FNA.21031800	PAD			
91	FNA.43044000	ROCKER SWITCH PIN			
92	FNA.43043900	VALVE CORE			
93	FNA.21033200	SCREW			
93-1	FNA.21009700	SCREW			
94	FNA.33000800	MAIN SWITCH			
95	FNA.22006400	RUBBER STOP			
96	FNA.22006300	CAPACITOR O-RING			
97	FNA.37009600	CAPACITOR			
103	FNA.42027000	SWITCH COVER			
104	FNA.22006200	COVER GASKET			
105	FNA.21035300	SCREW			
106	FNA.21031600	PLAIN PAD			
107	FNA.22006900	PADESTAL SMALL O-RING			
108	FNA.42027600	SWITCH PEDESTAL			
109	FNA.22007100	PEDESTAL BIG O-RING			
	<b>PC2950.V4.K14</b>	<b>MICRO SWITCH ASS'Y</b>			
98	FNA.37000100	SLOT			
98-1	FNA.37009200	SHORT STRAIGHT INSERT			
99	FNA.37000200	SLEEVE			
99-1	FNA.37007900	SLEEVE			
100	FNA.31002400	CORD			
	<b>PC2950.V5.K15</b>	<b>HANDLE ASS'Y</b>			
110	FNA.41005600	HANDLE FRAME BAND			
111	FNA.42027800	HANDLE SHELF			
112	FNA.42027400	HANDLE			
113	FNA.42027500	CABLE HOOKING			
114	FNA.21011700	SCREW			
115	FNA.21011700	SCREW			
123	FNA.10090200	SOAP BOTTLE (NO HOOK)			
	<b>PC2950.V4.K17</b>	<b>CABLE ASS'Y</b>			
46	FNA.31002801	CABLE			
47	FNA.41005300	CABLE SLEEVE			
95	FNA.22006400	RUBBER STOP			
98	FNA.37000100	SLOT			
99	FNA.37000200	SLEEVE			
	<b>PC2950.V5.K20</b>	<b>HOUSING ASS'Y</b>			
31	FNA.42021600	INLET COVER			
36	FNA.42044500	INLET NUT			
37	FNA.21008600	MOTOR BOLT			
38	FNA.21011700	SCREW			
39	FNA.41005100	BACK-UP PAD			
39-1	FNA.43064800	BACK PAD			
40	FNA.41005200	MOTOR FOOT			
41	FNA.61004100	BAFFLE			
42	FNA.42049900	BACK CASE			
43	FNA.42023100	CLAMPING PLATE			
44	FNA.21009700	SCREW			
48	FNA.43012700	BUCKLE			
49	FNA.21011700	SCREW			
50	FNA.41005400	FOOT			
51	FNA.21035600	SCREW			
52	FNA.42145600	FRONT CASE			
53	FNA.42027700	WHEEL COVER (HUB CAP)			
54	FNA.21032600	C-RING			
55	FNA.42027300	WHEEL			
56	FNA.43012800	WHEEL SHAFT			
57	FNA.42045300	OUTLET COVER			
110	FNA.41005600	HANDLE FRAME BAND			
111	FNA.42027800	HANDLE SHELF			
112	FNA.42027400	HANDLE			
113	FNA.42027500	CABLE HOOKING			
114	FNA.21011700	SCREW			
115	FNA.21011700	SCREW			
123	FNA.10090200	SOAP BOTTLE (NO HOOK)			

## ACCESSORIES

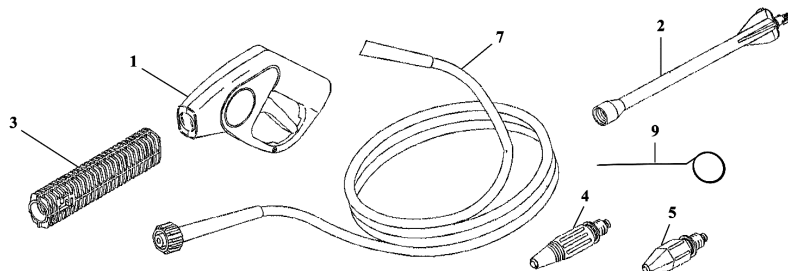

ITEM	PART NO	DESCRIPTION
1	FNA.10009500	GUN
2	FNA.10011200	LANCE
3	FNA.10009400	HALF LANCE
4	FNA.10009300	JET NOZZLE
5	FNA.10018400	TURBO ROTABLAST NOZZLE
7	FNA.42031101	HOSE
9	FNA.81001700	NEEDLE PROBE

**NOTE:** It is our policy to continually improve products and as such we reserve the right to alter data, specifications and component parts without prior notice.

**IMPORTANT:** No liability is accepted for incorrect use of product.

**WARRANTY:** Guarantee is 12 months from purchase date, proof of which will be required for any claim.

**INFORMATION:** For a copy of our latest catalogue and promotions call us on 01284 757525 and leave your full name and address, including postcode.