

Issue: 1
 Date Issued: 16/03/2009

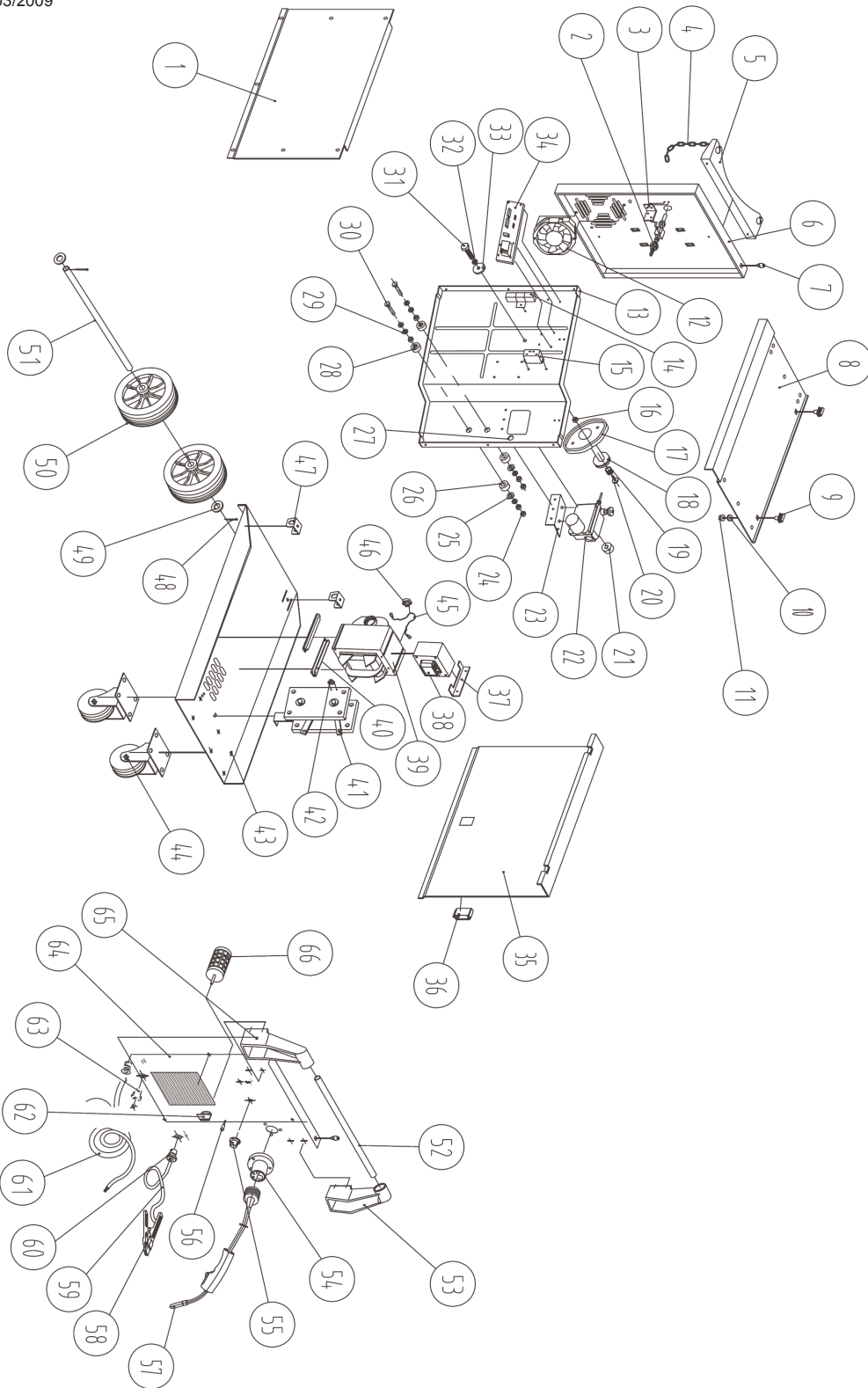

NOTE: It is our policy to continually improve products and as such we reserve the right to alter data, specifications and component parts without prior notice.

IMPORTANT: No liability is accepted for incorrect use of product.

WARRANTY: Guarantee is 12 months from purchase date, proof of which will be required for any claim.

INFORMATION: For a copy of our latest catalogue and promotions call us on 01284 757525 and leave your full name and address, including postcode.



PARTS LIST FOR:
**PROFESSIONAL GAS/NO GAS MIG
 WELDER 170AMP WITH EURO TORCH**
 MODEL: **MIGHTYMIG170**

ITEM	PART NO	DESCRIPTION	ITEM	PART NO	DESCRIPTION
1	M/MIG170.01	Side Panel	34	M/MIG170.34	Wire Feed PCB
2	M/MIG170.02	Valve Assembly	35	M/MIG170.35	Access Panel
3	M/MIG170.03	Valve Bracket	36	M/MIG170.36	Latch
4	M/MIG170.04	Cylinder Straps	37	M/MIG170.37	Filter Bracket
5	M/MIG170.05	Gas Bottle Support	38	M/MIG170.38	Filter Reactor
6	M/MIG170.06	Back Panel	39	M/MIG170.39	Transformer
7	M/MIG170.07	Rubber Support	40	M/MIG170.40	Transformer Support
8	M/MIG170.08	Top Panel	41	M/MIG170.41	Rectifier Support
9	M/MIG170.09	Hinge	42	M/MIG170.42	Switch
10	M/MIG170.10	Rubber Washer	43	M/MIG170.43	Bottom Panel
11	M/MIG170.11	Nut,M8	44	M/MIG170.44	Castor Wheel
12	M/MIG170.12	Fan	45	M/MIG170.45	Switch Bracket
13	M/MIG170.13	Inner Panel	46	M/MIG170.46	Thermal Switch
14	M/MIG170.14	Resistance	47	M/MIG170.47	Axle Bracket
15	M/MIG170.15	Relay	48	M/MIG170.48	Pin
16	M/MIG170.16	Nut,M10	49	M/MIG170.49	Washer
17	M/MIG170.17	Axle	50	M/MIG170.50	Wheel
18	M/MIG170.18	Knob (A)	51	M/MIG170.51	Axle
19	M/MIG170.19	Spring	52	M/MIG170.52	Handle
20	M/MIG170.20	Knob (B)	53	M/MIG170.53	Handle Support (Right)
21	M/MIG170.21	Wire Feed Roller	54	M/MIG170.54	Torch Holder
22	M/MIG170.22	Wire Feed Motor	55	M/MIG170.55	Speed Control Knob
23	M/MIG170.23	Wire Feed Support	56	M/MIG170.56	Overload Indicator Light
24	M/MIG170.24	Nut M8	57	M/MIG170.57	Welding Torch (MB14)
25	M/MIG170.25	Washer	58	M/MIG170.58	Clamp (Earth)
26	M/MIG170.26	Insulating Washer	59	M/MIG170.59	Earth Cable
27	M/MIG170.27	Line Out Ring	60	M/MIG170.60	Cable Tip
28	M/MIG170.28	Insulating Washer	61	M/MIG170.61	Line Cable
29	M/MIG170.29	Washer	62	M/MIG170.62	Voltage Control Knob
30	M/MIG170.30	Bolt M8 x 55mm	63	M/MIG170.63	Cable Tip
31	M/MIG170.31	Bolt 10 x 50mm	64	M/MIG170.64	Front Panel
32	M/MIG170.32	Spring Washer	65	M/MIG170.65	Handle Support (Left)
33	M/MIG170.33	Washer M10	66	M/MIG170.66	Voltage Control Switch

Issue: 1
 Date Issued: 16/03/2009

NOTE: It is our policy to continually improve products and as such we reserve the right to alter data, specifications and component parts without prior notice.
IMPORTANT: No liability is accepted for incorrect use of product.
WARRANTY: Guarantee is 12 months from purchase date, proof of which will be required for any claim.
INFORMATION: For a copy of our latest catalogue and promotions call us on 01284 757525 and leave your full name and address, including postcode.

	Sole UK Distributor Sealey Group, Bury St. Edmunds, Suffolk.	01284 757500 01284 703534	www.sealey.co.uk sales@sealey.co.uk
--	--	--	--