



INSTRUCTIONS FOR:

AUTO REWIND CONTROL AIR HOSE REELS

MODEL NO: **SA821.V2, SA822.V2, SA823.V2
SA824.V2**

Thank you for purchasing a Sealey product. Manufactured to a high standard this product will, if used according to these instructions and properly maintained, give you years of trouble free performance.

IMPORTANT: PLEASE READ THESE INSTRUCTIONS CAREFULLY. NOTE THE SAFE OPERATIONAL REQUIREMENTS, WARNINGS & CAUTIONS. USE THE PRODUCT CORRECTLY AND WITH CARE FOR THE PURPOSE FOR WHICH IT IS INTENDED. FAILURE TO DO SO MAY CAUSE DAMAGE AND/OR PERSONAL INJURY AND WILL INVALIDATE THE WARRANTY. PLEASE KEEP INSTRUCTIONS SAFE FOR FUTURE USE.



Refer to the instruction manual



Wear eye protection

1. SAFETY

- ✓ Familiarise yourself with the application and limitations of the air hose reel, as well as the specific hazards.
- ❑ **WARNING!** Disconnect the air hose reel from the air supply before servicing or performing any maintenance.
- ✓ Maintain the air hose reel in good condition (use an authorised service agent).
- ✓ Replace or repair damaged parts. *Use recommended parts only. Unauthorised parts may be dangerous and will invalidate the warranty.*
- ✓ Locate and fix the air hose reel in a suitable working area, ensure that the correct fixings are used to secure the unit to the wall.
- ✗ **DO NOT** position the hose in direct sunlight, or in areas of extreme heat or cold.
- ✗ **DO NOT** mount inside a spray booth/oven.
- ✓ Ensure there is adequate lighting.
- ❑ **WARNING!** Ensure maximum air pressure is not exceeded (250psi/17bar).
- ✓ Keep extended air hose away from heat, oil and sharp edges.
- ✓ Check hose for wear before each use and ensure all connections are secure.
- ✓ Keep the unrolled air hose away from wet, damp, oily surfaces to avoid debris accumulation inside the housing.
- ❑ **WARNING!** Always wear approved eye when operating the air hose reel.
- ✓ Maintain correct balance and footing. Ensure the floor is not slippery and wear non-slip shoes.
- ✓ Keep children and unauthorised persons away from the working area.
- ✗ **DO NOT** operate the air hose reel if any parts are damaged or missing as this may cause failure and/or personal injury.
- ✗ **DO NOT** use the air hose reel for any purpose other than that for which it is designed.
- ✗ **DO NOT** yank the hose from the air supply.
- ✗ **DO NOT** operate the air hose reel when you are tired or under the influence of alcohol, drugs or intoxicating medication.
- ✗ **DO NOT** direct air from the air hose at yourself or others.
- ✓ When not in use ensure the air supply is turned off and tools disconnected. Disconnect from the air supply and retract the hose into case.
- ❑ **WARNING! DO NOT** dismantle the hose reel casing. *To do so may result in damage to the appliance and/or personal injury and will invalidate the warranty. Internal maintenance, which will require the opening of the casing, must only be undertaken by an authorised service agent.*

2. INTRODUCTION

Composite housing with heavy-duty wall mounting swivel bracket. Model No. SA821.V2 fitted with high quality Ø8mm ID PU hose. Model No's SA822.V2, SA823.V2 and SA824.V2 supplied with high quality Ø10mm ID rubber hose. Innovative design features three key points. Hose can be extended and stopped at any length. Controlled, slow rewind which, unlike traditional retractable reels, returns the air hose at a safe speed. Auto layering mechanism distributes air hose evenly back into reel housing preventing it from jamming. Suitable for professional garages/workshops.

3. SPECIFICATION

MODEL No:.....SA821.V2....SA822.V2....SA823.V2....SA824.V2
 Hose length:.....10M.....15M.....20M.....30M
 Hose Size ID/OD:.....8/12mm...10/16.5mm...10/16.5mm...10/16.5mm
 Maximum pressure:.....250psi.....250psi.....250psi.....250psi
 Hose type:.....PU.....Rubber.....Rubber.....Rubber
 Inlet/Outlet:.....1/4"BSP.....1/4"BSP.....1/4"BSP.....1/4"BSP

4. CONTENTS

Item	Description	Qty	Remarks
1	Hose Reel c/w Housing	1	Auto rewind
2	Pivot Bracket	1	Composite
3	Cross Head S/T Screw (plated)	4	No 14 x 48mm
4	Plastic Plug	4	Ø9.5mm x 45mm

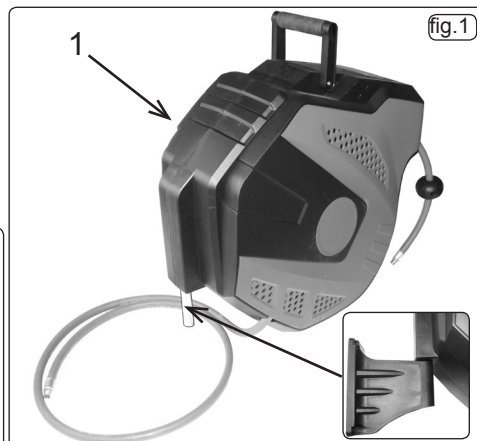
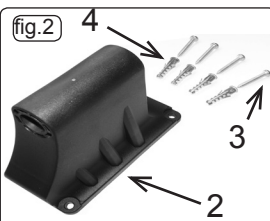

5. OPERATION

- ❑ **WARNING!** Ensure the hose is disconnected from the air supply. **DO NOT** position the hose in direct sunlight or in areas of extreme heat or cold. A clearance of 750mm either side of the pivot position is required for a full 180° sweep of the casing.
- 5.1. Wall mounting.**
 - 5.1.1. Remove all items from the packaging.
 - 5.1.2. Using the pivot bracket, item 2, as a template, mark the wall or substantial post, where the hose reel is to be mounted and drill four 10mm diameter holes 50mm deep, 40mm centres horizontally and 164mm vertically. (Suggest 800mm approximately from the floor to the under edge of the hose reel casing)
 - 5.1.3. Insert the four plastic plugs, item 4, into the holes and mount the bracket securely, flat face uppermost (fig.1), with the four self tapping screws, item 3.
 - 5.1.4. With assistance, offer the hose reel pivot shaft into the pivot bracket, check for full sweep angle. No further fitting required.
 - 5.1.5. Connect to an air line. **DO NOT** connect directly to an air tool, connect a leader hose to the tool first and then connect the leader hose to the air hose reel.
- 5.2. Extending the hose.**
 - 5.2.1. Pull the hose out slowly to the length required and stop, pause momentarily to enable the ratchet to engage. Operate the air line by opening the faucet, tap or valve.
- 5.3. Retracting the hose.**
 - 5.3.1. Close the faucet, tap or valve. To release the hose and allow it to automatically rewind, pull the hose out from the locked position and then release the tension on the hose. Carry the air tool with the hose back to the hose reel housing.
- ❑ **WARNING!** The reel tension is factory set, if any adjustment is required contact an authorised service agent.

6. MAINTENANCE

- ❑ **WARNING! Before attempting maintenance or inspection, vent any pressure remaining in the hose.**
To ensure reliable operation, clean the hose and casing regularly. **DO NOT** spray or wet the product, but clean with a damp cloth and warm water. **DO NOT** use solvents or detergents, as these may permanently damage the item. The hose reel does not require special maintenance as it is lubricated for life. If the product needs to be opened, consult your nearest authorised service agent.
- ❑ **WARNING: DO NOT attempt to loosen, or remove, any casing screws yourself.**
Replacement of the supply hose should be carried out by skilled personnel only, consult your nearest authorised service agent.
STORAGE: Before storing the air hose, ensure it is clean and dry. Store it in a dark, safe, dry, childproof location, where the temperature will remain reasonably stable.

7. TROUBLESHOOTING

Fault	Possible Cause	Possible remedy
Hose will not retract	Hose extended too far and locked	Open the top lid and turn the reel to free the lock. (fig.3)
	The spring has lost some torsion	Contact an authorised service agent. DO NOT attempt the repair yourself.
	Hose twisted in housing.	Draw the hose from the reel to check.
	Torsion (main spring) fatigued.	Contact an authorised service agent. DO NOT attempt the repair yourself.



Environmental Protection

Recycle unwanted materials instead of disposing of them as waste. All tools, accessories and packaging should be sorted, taken to a recycling centre and disposed of in a manner which is compatible with the environment. When the product becomes completely unserviceable and requires disposal, dispose of the product according to local regulations.

NOTE: It is our policy to continually improve products and as such we reserve the right to alter data, specifications and component parts without prior notice.

IMPORTANT: No liability is accepted for incorrect use of this product.

WARRANTY: Guarantee is 12 months from purchase date, proof of which will be required for any claim.



SEALEY

Sole UK Distributor, Sealey Group,
Kempson Way, Suffolk Business Park,
Bury St. Edmunds, Suffolk
IP32 7AR



01284 757500

01284 703534



www.sealey.co.uk



sales@sealey.co.uk